

PROFILE RANGE 8



PAGE 14



PAGE 14



PAGE 14



PAGE 14



PAGE 15



PAGE 15

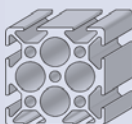

PAGE 15



PAGE 16



PAGE 16



PAGE 17



PAGE 17



PAGE 17

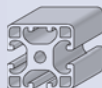

PAGE 18

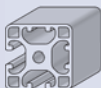

PAGE 18

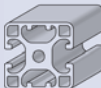

PAGE 18

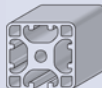

PAGE 18



PAGE 19



PAGE 19



PAGE 19



PAGE 19

PROFILE RANGE 8

ALVÁRIS
PROFILE SYSTEMS

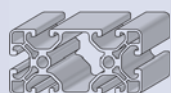

PAGE 20

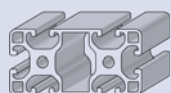

PAGE 20



PAGE 20



PAGE 21



PAGE 21



PAGE 21



PAGE 22



PAGE 22



PAGE 23



PAGE 23

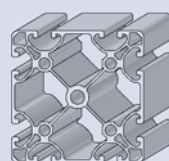

PAGE 24

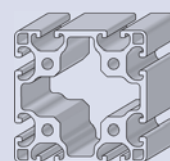

PAGE 24

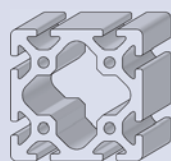

PAGE 25

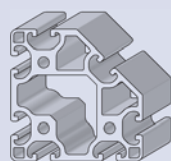

PAGE 25

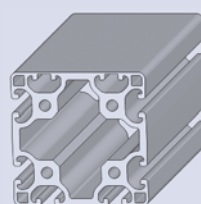

PAGE 26

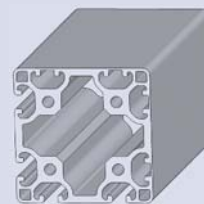

PAGE 26



PAGE 27



PAGE 27

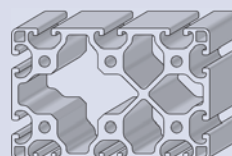

PAGE 28

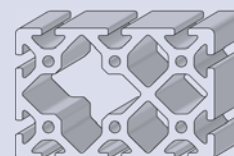













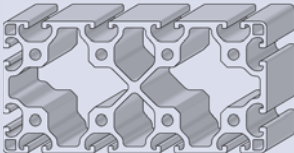
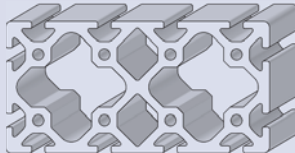

PAGE 28

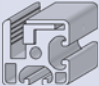
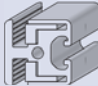
PROFILE RANGE 8

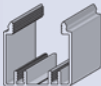
ALVÁRIS
PROFILE SYSTEMS

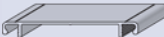
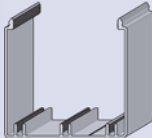

			
PAGE 29	PAGE 29	PAGE 30	PAGE 30
			
PAGE 31	PAGE 31	PAGE 32	PAGE 32
			
PAGE 33	PAGE 33	PAGE 33	PAGE 34
			
PAGE 34	PAGE 34	PAGE 35	PAGE 35
			
PAGE 35	PAGE 36	PAGE 37	

PROFILE RANGE 8

Profile 8 30x30

ORDER N°. PRO8.3030

L=6000+30 mm

m=0,9kg/m

A=3,29cm²

W_x=2,16cm³

W_y=2,16cm³

I_x=3,13cm⁴

I_y=3,13cm⁴

Profile for light and cost-effective constructions. The 8mm wide longitudinal grooves allow standard sliding blocks (except for sliding blocks with ridge, heavy) to be inserted. When slewing in ensure that correct direction is used, since the groove is asymmetrically shaped.

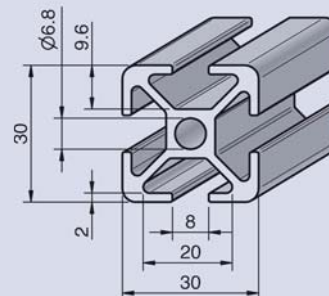

Profile 8 30x30 1N

ORDER N°. PRO8.30301N

L=6000+30 mm

m=0,92kg/m

A=3,29cm²

W_x=2,26cm³

W_y=1,08cm³

I_x=3,45cm⁴

I_y=2,64cm⁴

Profiles for light-weight and economic structures with a closed groove to protect against dirt penetration and to act as a visual feature. The width of the groove is 8 mm and permits the use of standard T nuts (except for T nuts with a „heavy“ spacer). Because of the asymmetric shape, be sure to select the correct direction of insertion.

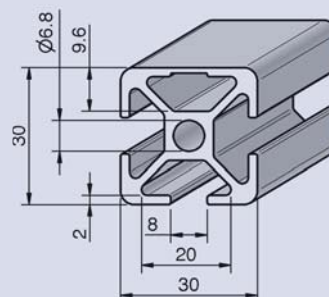

Profile 8 30x30 2N 90°

ORDER N°. PRO8.30302N90

L=6000+30 mm

m=0,95kg/m

A=3,51cm²

W_x=2,26cm³

W_y=2,26cm³

I_x=3,45cm⁴

I_y=3,45cm⁴

Profiles for light-weight and economic structures with a closed groove to protect against dirt penetration and to act as a visual feature. The width of the groove is 8 mm and permits the use of standard T nuts (except for T nuts with a „heavy“ spacer). Because of the asymmetric shape, be sure to select the correct direction of insertion.

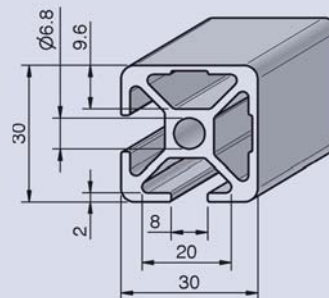

Profile 8 R30 90°

ORDER N°. PRO8.R3090

L=6000+30 mm

m=0,83kg/m

A=3,06cm²

W_x=1,72cm³

W_y=1,70cm³

I_x=2,68cm⁴

I_y=2,62cm⁴

Profile for bracing, cover hoods, display cases, tables and other decorative visible surfaces. The groove width of 8 mm makes possible the use of standard groove stones (except for groove stones with heavy base). Due to the asymmetric groove form, the pivoting direction is to be taken into consideration.

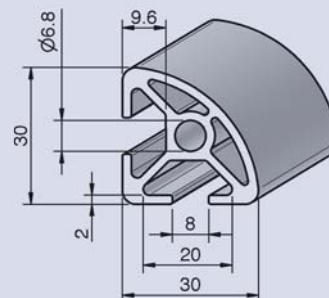

PROFILE RANGE 8



Profile 8 60x30

ORDER N°. PRO8.6030

L=6000+30 mm

m=1,84kg/m

A=6,83cm²

W_x=4,53cm³

W_y=7,49cm³

I_x=6,81cm⁴

I_y=22,68cm⁴

Profile for light and cost-effective constructions. The 8mm wide longitudinal grooves allow standard sliding blocks (except for sliding blocks with ridge, heavy) to be inserted. When slewing in ensure that correct direction is used, since the groove is asymmetrically shaped.

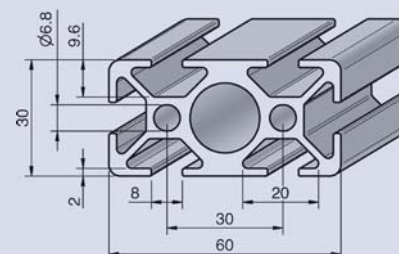

Profile 8 60x30 2N

ORDER N°. PRO8.60302N

L=6000+30 mm

m=1,92kg/m

A=7,11cm²

W_x=4,11cm³

W_y=8,09cm³

I_x=6,42cm⁴

I_y=22,43cm⁴

Profile for light and inexpensive constructions with closed groove against the infiltration of dirt and as decorative visible surface. The groove width of 8 mm makes possible the use of standard groove stones (except for groove stones with heavy base). Due to the asymmetric groove form, the pivoting direction is to be taken into consideration.

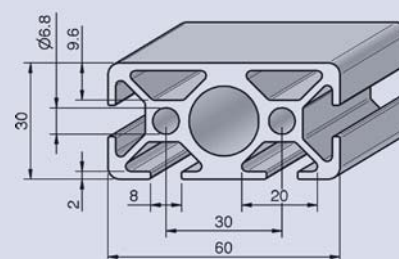

Profile 8 60x60

ORDER N°. PRO8.6060

L=6000+30 mm

m=2,63kg/m

A=13,50cm²

W_x=14,50cm³

W_y=14,50cm³

I_x=43,60cm⁴

I_y=43,60cm⁴

Profile for light and cost-effective constructions. The 8mm wide longitudinal grooves allow standard sliding blocks (except for sliding blocks with ridge, heavy) to be inserted. When slewing in ensure that correct direction is used, since the groove is asymmetrically shaped.

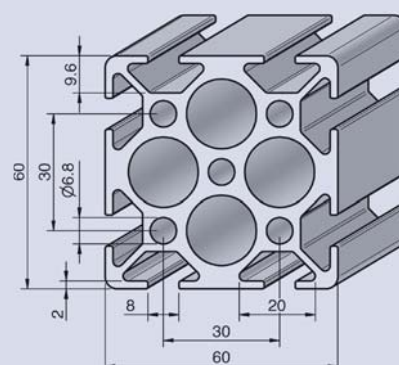

PROFILE RANGE 8

ALVÁRIS
PROFILE SYSTEMS

Profile 40x16E

ORDER N°. PRO4016E

L=6000+70mm

m=0,65kg/m

A=2,40cm²

W_x=0,81cm³

W_y=1,83cm³

I_x=0,65cm⁴

I_y=3,66cm⁴

Light-weight profile for constructions strongly restricted in terms of weight and price.

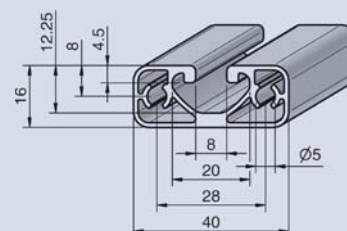

Profile 40x16

ORDER N°. PRO4016

L=6000+70mm

m=1,15kg/m

A=4,26cm²

W_x=1,24cm³

W_y=3,46cm³

I_x=1,06cm⁴

I_y=6,93cm⁴

Flat profile for handles, edge strips and various attachments.

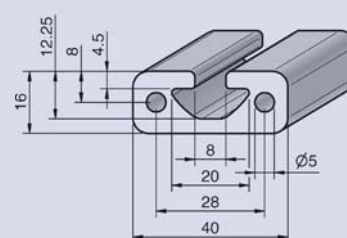

PROFILE RANGE 8

ALVÁRIS
PROFILE SYSTEMS



Profile 40x40E

ORDER N°. PRO4040E

L=6000+70mm

m=1,36kg/m

A=5,04cm²

W_x=3,67cm³

W_y=3,67cm³

I_x=7,34cm⁴

I_y=7,34cm⁴

Light-weight profile for constructions strongly restricted in terms of weight and price.

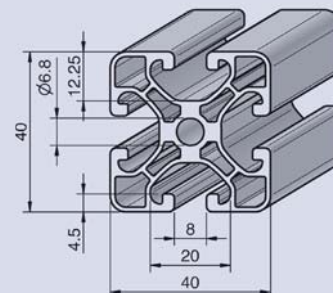

Profile 40x40L

ORDER N°. PRO4040L

L=6000+70mm

m=1,75kg/m

A=6,49cm²

W_x=4,54cm³

W_y=4,54cm³

I_x=9,08cm⁴

I_y=9,08cm⁴

Light-weight profile for constructions restricted in terms of weight and price.

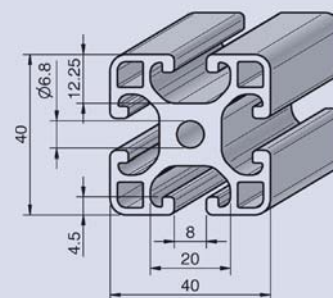

Profile 40x40

ORDER N°. PRO4040

L=6000+70mm

m=2,48kg/m

A=9,20cm²

W_x=7,02cm³

W_y=7,02cm³

I_x=14,00cm⁴

I_y=14,00cm⁴

Profile for general constructions.

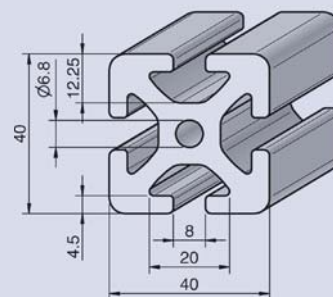

PROFILE RANGE 8

ALVÁRIS
PROFILE SYSTEMS

Profile 40x40L 1N

ORDER N°. PRO4040L1N

L=6000+70mm

m=1,81kg/m

A=6,68cm²

W_x=4,75cm³

W_y=4,55cm³

I_x=9,75cm⁴

I_y=9,10cm⁴

Light-weight profile with closed groove for dirt penetration prevention or as decorative frontal view.

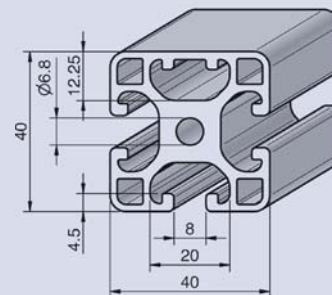

Profile 40x40L 2N 90°

ORDER N°. PRO4040L2N90

L=6000+70mm

m=1,86kg/m

A=6,87cm²

W_x=4,70cm³

W_y=4,70cm³

I_x=9,78cm⁴

I_y=9,78cm⁴

Light-weight profile with closed groove for dirt penetration prevention or as decorative frontal view.

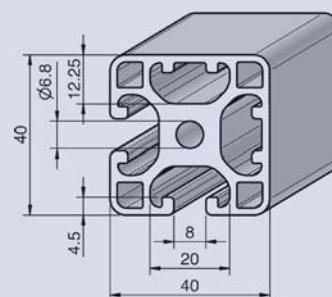

Profile 40x40L 2N 180°

ORDER N°. PRO4040L2N180

L=6000+70mm

m=1,86kg/m

A=6,84cm²

W_x=4,51cm³

W_y=5,05cm³

I_x=9,02cm⁴

I_y=10,11cm⁴

Light-weight profile with closed groove for dirt penetration prevention or as decorative frontal view.

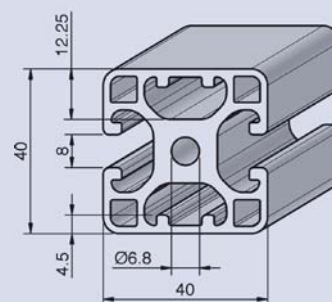

Profile 40x40L 3N

ORDER N°. PRO4040L3N

L=6000+70mm

m=1,90kg/m

A=6,96cm²

W_x=4,70cm³

W_y=5,11cm³

I_x=9,62cm⁴

I_y=10,22cm⁴

Light-weight profile with closed groove for dirt penetration prevention or as decorative frontal view.

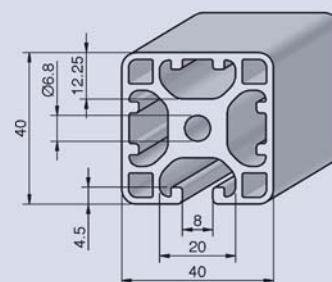

PROFILE RANGE 8

ALVÁRIS
PROFILE SYSTEMS



Profile 40x40L 45°

ORDER N°. PRO4040L45

L=6000+70mm

m=1,52kg/m

A=5,64cm²

W_x=2,97cm³

W_y=2,97cm³

I_x=6,65cm⁴

I_y=6,65cm⁴

Profile for cross-struts, covering caps, tables or other decorative visible surfaces.

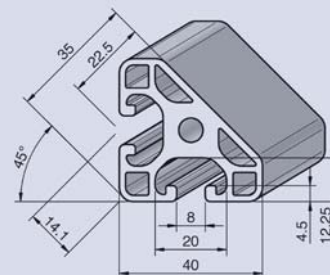

Profile 40x40 45°

ORDER N°. PRO404045

L=6000+70mm

m=1,97kg/m

A=7,30cm²

W_x=4,08cm³

W_y=4,08cm³

I_x=9,39cm⁴

I_y=9,39cm⁴

Profile for cross-struts, covering caps, tables or other decorative visible surfaces.

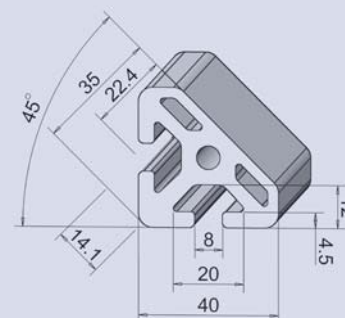

Profile R40L 90°

ORDER N°. PRO4040L90

L=6000+70mm

m=1,48kg/m

A=5,37cm²

W_x=2,95cm³

W_y=2,95cm³

I_x=6,58cm⁴

I_y=6,58cm⁴

Profile for cross-struts, covering caps, tables or other decorative visible surfaces.

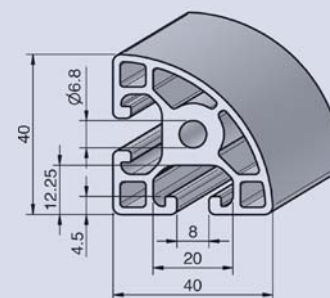

Profile 80x16

ORDER N°. PRO8016

L=6000+70mm

m=2,17kg/m

A=8,04cm²

W_x=2,51cm³

W_y=12,40cm³

I_x=2,18cm⁴

I_y=49,40cm⁴

Flat profile for handles, edge strips and various attachments.

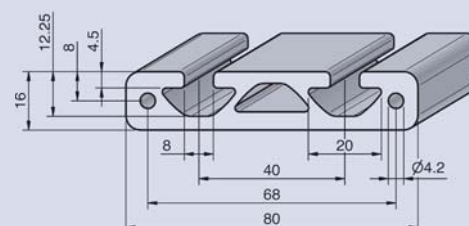

PROFILE RANGE 8

Profile 80x40E

ORDER N°. PRO8040E

L=6000+70mm

m=2,37kg/m

A=8,73cm²

W_x=7,37cm³

W_y=14,40cm³

I_x=14,70cm⁴

I_y=57,70cm⁴

Light-weight profile for constructions strongly restricted in terms of weight and price.

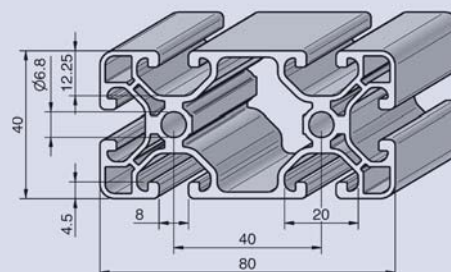

Profile 80x40L

ORDER N°. PRO8040L

L=6000+70mm

m=3,07kg/m

A=11,30cm²

W_x=8,37cm³

W_y=17,50cm³

I_x=16,80cm⁴

I_y=69,90cm⁴

Light-weight profile for constructions restricted in terms of weight and price.

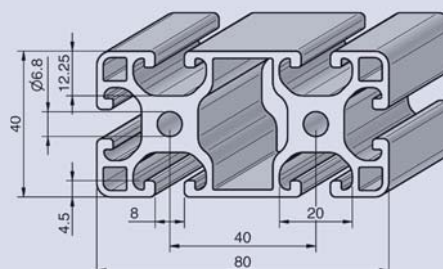

Profile 80x40

ORDER N°. PRO8040

L=6000+70mm

m=4,54kg/m

A=16,80cm²

W_x=13,50cm³

W_y=25,40cm³

I_x=27,00cm⁴

I_y=102,00cm⁴

Profile for general constructions. The large, closed cavity is suited as compressed air piping.

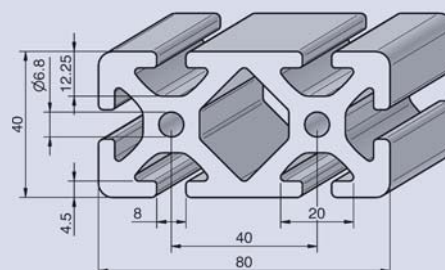

PROFILE RANGE 8

ALVÁRIS
PROFILE SYSTEMS



Profile 80x40L 1N

ORDER N°. PRO8040L1N

L=6000mm

m=3,11kg/m

A=11,53cm²

W_x=8,46cm³

W_y=17,81cm³

I_x=16,92cm⁴

I_y=72,13cm⁴

Light-weight profile with closed groove for dirt penetration prevention or as decorative frontal view.

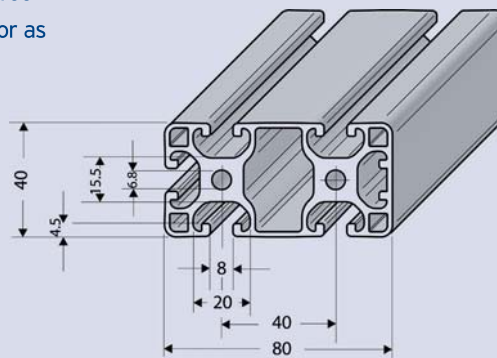

Profile 80x40L 2N

ORDER N°. PRO8040L2N

L=6000+70mm

m=3,11kg/m

A=11,58cm²

W_x=8,81cm³

W_y=17,71cm³

I_x=17,71cm⁴

I_y=70,85cm⁴

Light-weight profile with closed groove for dirt penetration prevention or as decorative frontal view.

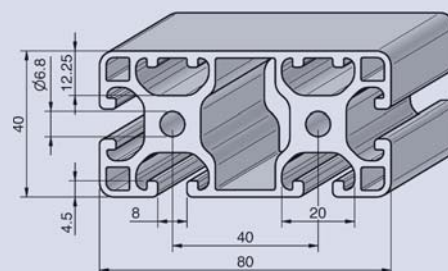

Profile 80x40L 3N 90°

ORDER N°. PRO8040L3N90

L=6000mm

m=3,20kg/m

A=11,75cm²

W_x=8,63cm³

W_y=17,81cm³

I_x=17,73cm⁴

I_y=72,13cm⁴

Light-weight profile with closed groove for dirt penetration prevention or as decorative frontal view.

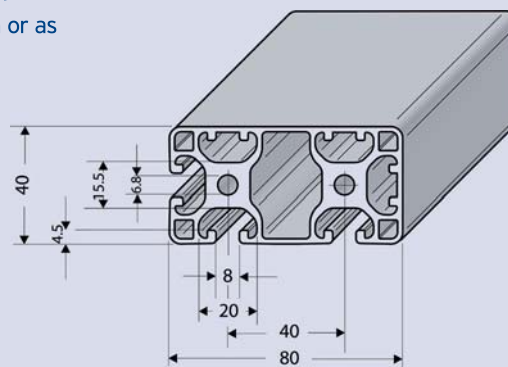

PROFILE RANGE 8

ALVÁRIS
PROFILE SYSTEMS

Profile R40/80 30°

ORDER N°. PROR408030

L=6000+70mm

m=1,32kg/m

A=4,88cm²

W_x=2,27cm³

W_y=2,84cm³

I_x=5,14cm⁴

I_y=6,57cm⁴

Profile for cross-struts, covering caps, tables or other decorative visible surfaces.

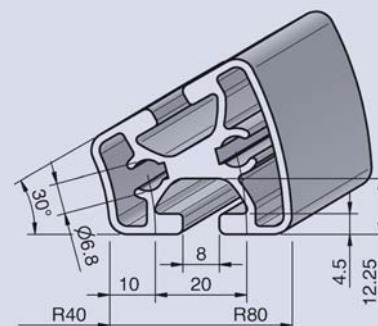

Profile R40/80 45°

ORDER N°. PROR408045

L=6000+70mm

m=2,73kg/m

A=10,00cm²

W_x=6,93cm³

W_y=6,33cm³

I_x=22,00cm⁴

I_y=16,50cm⁴

Profile for cross-struts, covering caps, tables or other decorative visible surfaces.

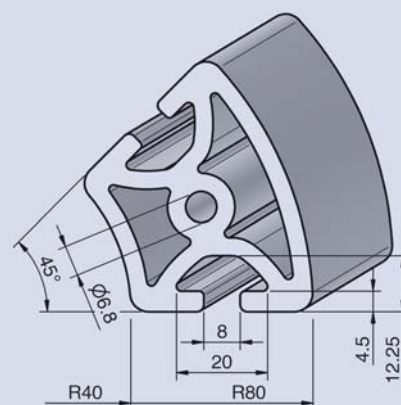

PROFILE RANGE 8

ALVÁRIS
PROFILE SYSTEMS



Profile R40/80 60°

ORDER N°. PROR408060

L=6000+70mm

m=2,19kg/m

A=8,08cm²

W_x=8,47cm³

W_y=6,69cm³

I_x=32,60cm⁴

I_y=19,60cm⁴

Profile for cross-struts, covering caps, tables or other decorative visible surfaces.

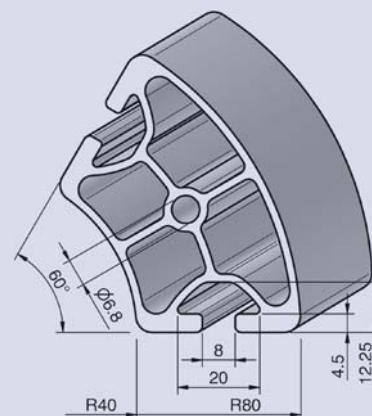

Profile R40/80 90°

ORDER N°. PROR408090

L=6000+70mm

m=3,46kg/m

A=12,80cm²

W_x=17,10cm³

W_y=17,10cm³

I_x=69,00cm⁴

I_y=69,00cm⁴

Profile for cross-struts, covering caps, tables or other decorative visible surfaces.

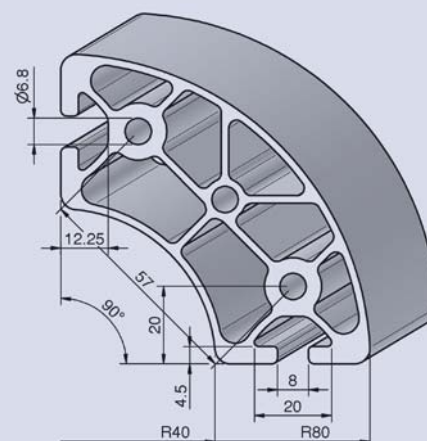

PROFILE RANGE 8

ALVÁRIS
PROFILE SYSTEMS

Profile 80x80E

ORDER N°. PRO8080E

L=6000+70mm

m=4,00kg/m

A=14,86cm²

W_x=25,17cm³

W_y=25,17cm³

I_x=100,69cm⁴

I_y=100,69cm⁴

Light-weight profile for constructions strongly restricted in terms of weight and price.

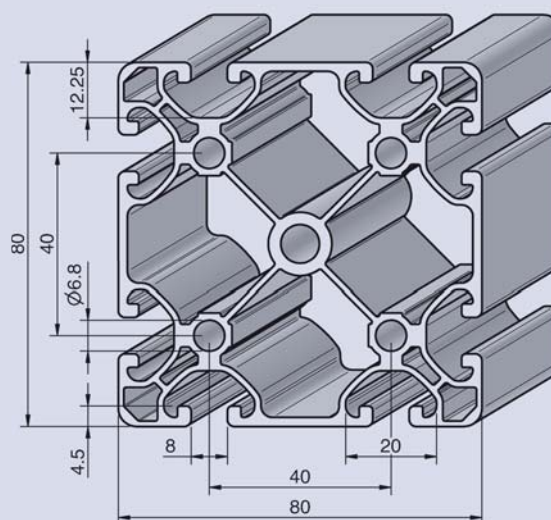

Profile 80x80L

ORDER N°. PRO8080L

L=6000+70mm

m=5,19kg/m

A=19,20cm²

W_x=32,80cm³

W_y=32,80cm³

I_x=131,00cm⁴

I_y=131,00cm⁴

Light-weight profile for constructions restricted in terms of weight and price.

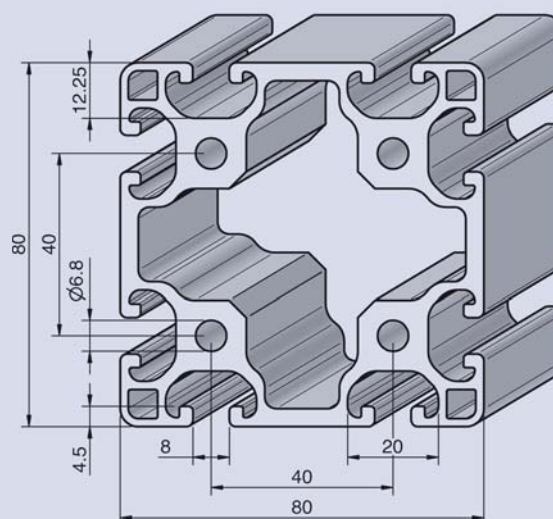

PROFILE RANGE 8

ALVÁRIS
PROFILE SYSTEMS



Profile 80x80

ORDER N°. PRO8080

L=6000+70mm

m=7,14kg/m

A=26,30cm²

W_x=46,60cm³

W_y=46,60cm³

I_x=186,00cm⁴

I_y=186,00cm⁴

Profile for general constructions. The large, closed cavity is suited as compressed air piping.

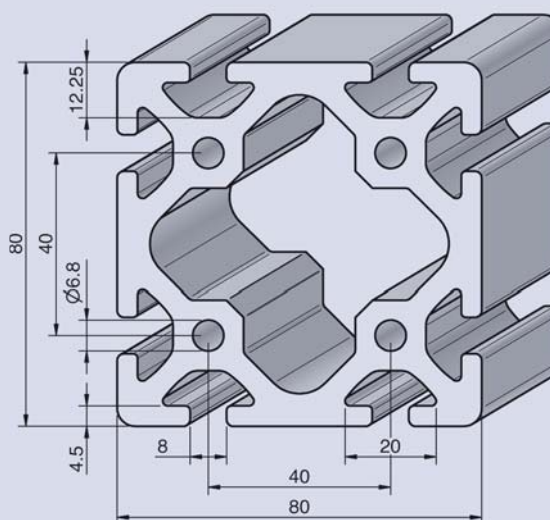

Profile 80x80L 45°

ORDER N°. PRO8080L45

L=6000+70mm

m=4,99kg/m

A=18,30cm²

W_x=24,40cm³

W_y=24,40cm³

I_x=107,00cm⁴

I_y=107,00cm⁴

Light-weight profile for corner constructions and cross-struts.

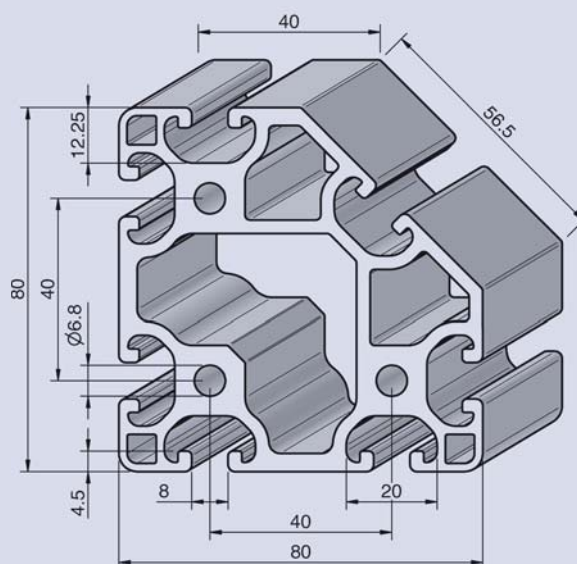

PROFILE RANGE 8

ALVÁRIS
PROFILE SYSTEMS

Profile 80x80L 2N

ORDER N°. PRO8080L2N

L=6000mm

m=5,42kg/m

A=20,08cm²

W_x=34,25cm³

W_y=34,25cm³

I_x=139,01cm⁴

I_y=139,01cm⁴

Light-weight profile with closed groove for dirt penetration prevention or as decorative frontal view.

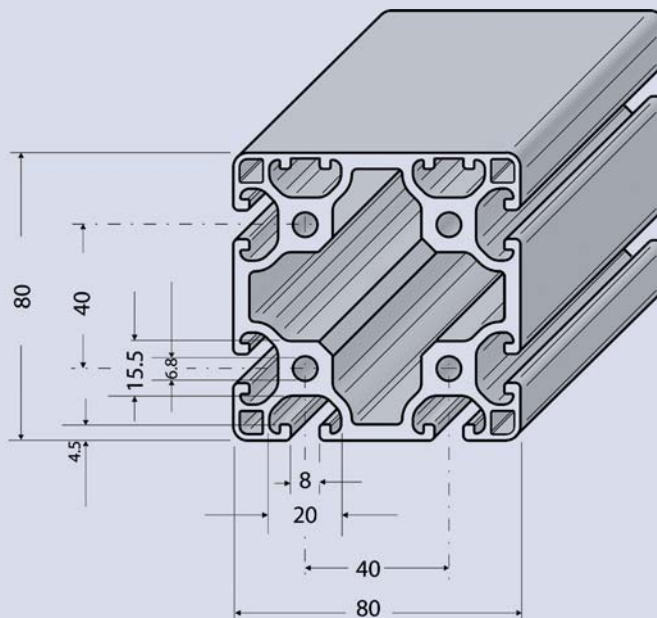

Profile 80x80L 4N 90°

ORDER N°. PRO8080L4N90

L=6000mm

m=5,50kg/m

A=20,39cm²

W_x=34,48cm³

W_y=34,48cm³

I_x=140,01cm⁴

I_y=140,01cm⁴

Light-weight profile with closed groove for dirt penetration prevention or as decorative frontal view.

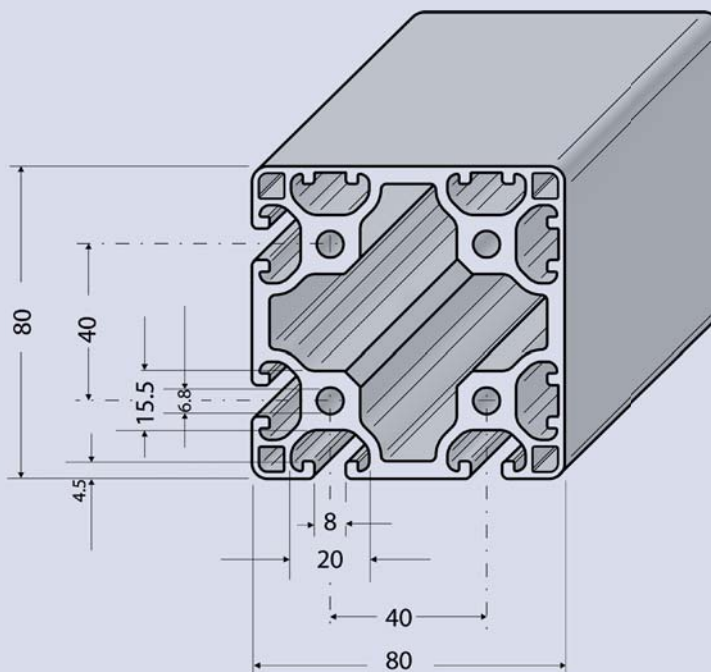

PROFILE RANGE 8

ALVÁRIS
PROFILE SYSTEMS



Profile 120x40L

ORDER N°. PRO12040L

L=6000+70mm

m=4,38kg/m

A=16,20cm²

W_x=12,20cm³

W_y=36,90cm³

I_x=24,40cm⁴

I_y=222,00cm⁴

Light-weight profile for constructions restricted in terms of weight and price.

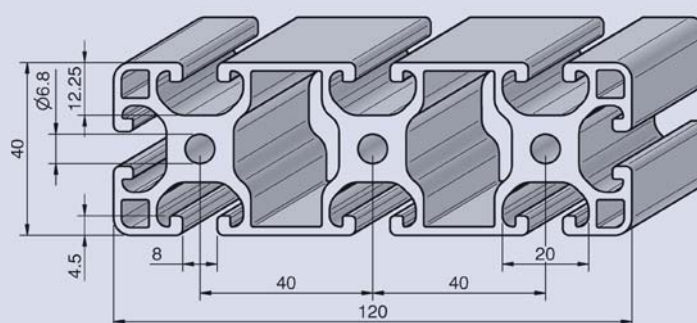

Profile 120x40

ORDER N°. PRO12040

L=6000+70mm

m=6,66kg/m

A=24,60cm²

W_x=20,20cm³

W_y=54,40cm³

I_x=40,40cm⁴

I_y=326,00cm⁴

Profile for general constructions. The large, closed cavity is suited as compressed air piping.

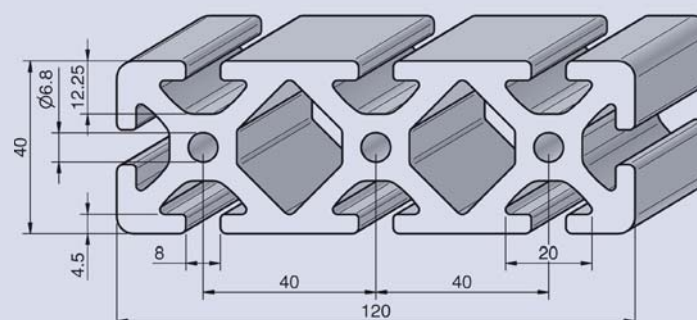

PROFILE RANGE 8

ALVÁRIS
PROFILE SYSTEMS

Profile 120x80L

ORDER N°. PRO12080L

L=6000+70mm

m=8,12kg/m

A=30,00cm²

W_x=50,96cm³

W_y=68,92cm³

I_x=203,82cm⁴

I_y=424,82cm⁴

Light-weight profile for constructions restricted in terms of weight and price.

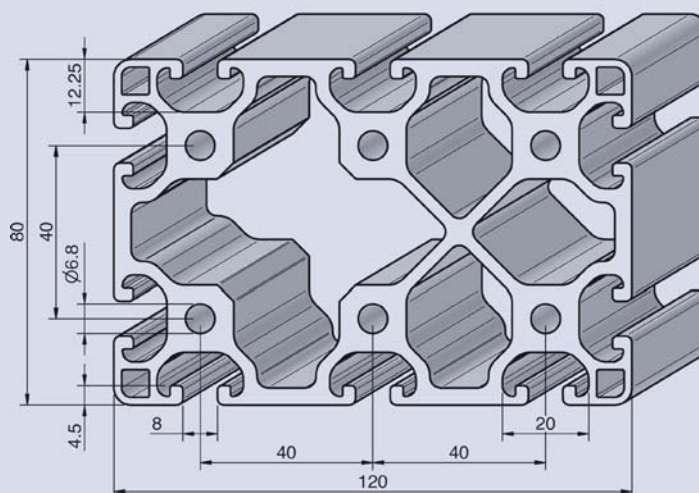

Profile 120x80

ORDER N°. PRO12080

L=6000+70mm

m=10,43kg/m

A=38,50cm²

W_x=66,80cm³

W_y=90,20cm³

I_x=267,00cm⁴

I_y=560,00cm⁴

Profile for general constructions.

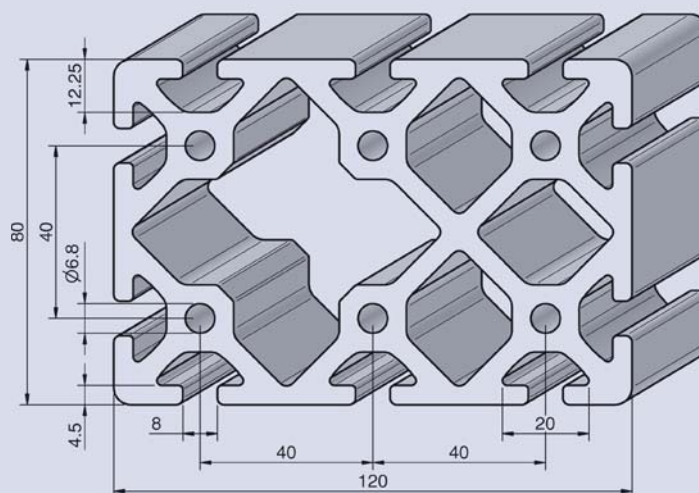

PROFILE RANGE 8

ALVÁRIS
PROFILE SYSTEMS



Profile 160x16

ORDER N°. PRO16016

L=6000+70mm

m=3,75kg/m

A=13,82cm²

Wx=4,21cm³

Wy=38,36cm³

Ix=3,85cm⁴

Iy=306,89cm⁴

The flat profile is suitable as platform for universal machine tables used for processing pieces, for electr. switch cabinet systems or as point of intersection between Range 8 and Range 5. For corresponding system modules see Accessories Range 8 and/or Range 5.

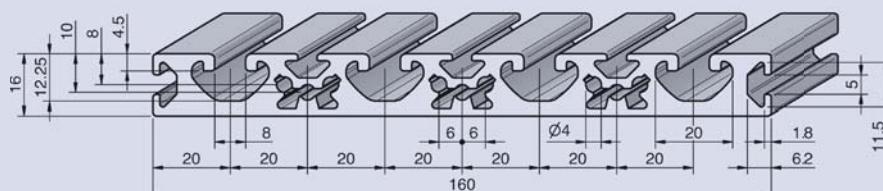

Profile 160x28

ORDER N°. PRO16028

L=6000mm

m=8,39kg/m

A=20,49cm²

Wx=14,33cm³

Wy=90,85cm³

Ix=20,49cm⁴

Iy=726,81cm⁴

The flat profile is suitable as platform for universal machine tables used for processing pieces, for electr. switch cabinet systems or as point of intersection between Range 8.

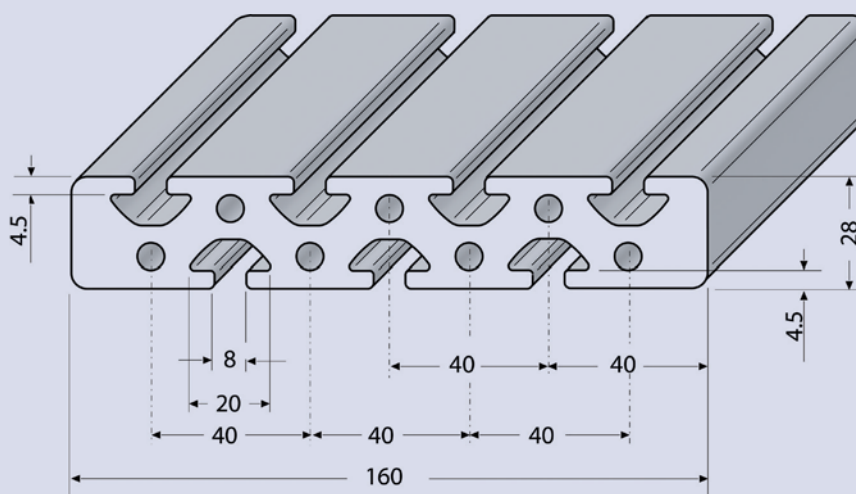

PROFILE RANGE 8

ALVÁRIS
PROFILE SYSTEMS

Profile 160x40L

ORDER N°. PRO16040L

L=6000+70mm

m=5,69kg/m

A=21,00cm²

W_x=16,00cm³

W_y=62,80cm³

I_x=32,00cm⁴

I_y=503,00cm⁴

Light-weight profile for constructions restricted in terms of weight and price.

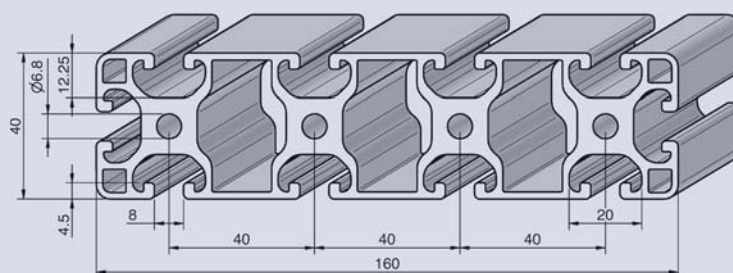

Profile 160x40

ORDER N°. PRO16040

L=6000+70mm

m=8,67kg/m

A=32,00cm²

W_x=26,36cm³

W_y=92,45cm³

I_x=52,72cm⁴

I_y=739,62cm⁴

Profile for general constructions.

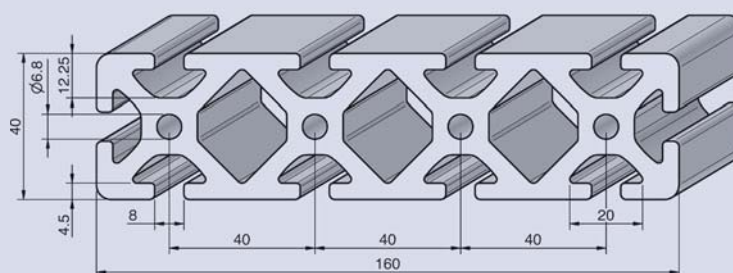

PROFILE RANGE 8

ALVÁRIS
PROFILE SYSTEMS



Profile 160x80L

ORDER N°. PRO16080L

L=6000+70mm

m=10,31kg/m

A=38,00cm²

W_x=67,60cm³

W_y=115,00cm³

I_x=270,00cm⁴

I_y=921,00cm⁴

Light-weight profile for constructions restricted in terms of weight and price.

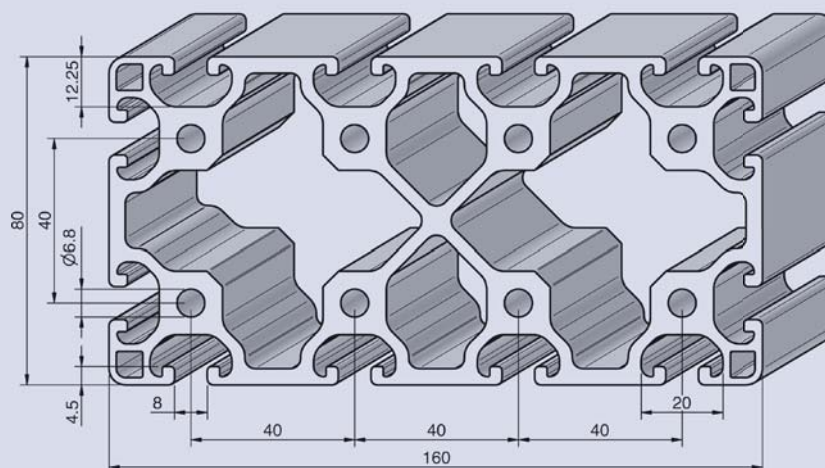

Profile 160x80

ORDER N°. PRO16080

L=6000+70mm

m=13,49kg/m

A=49,96cm²

W_x=90,52cm³

W_y=154,00cm³

I_x=362,15cm⁴

I_y=1.228,33cm⁴

Profile for general constructions. The large, closed cavity is suited as compressed air piping.

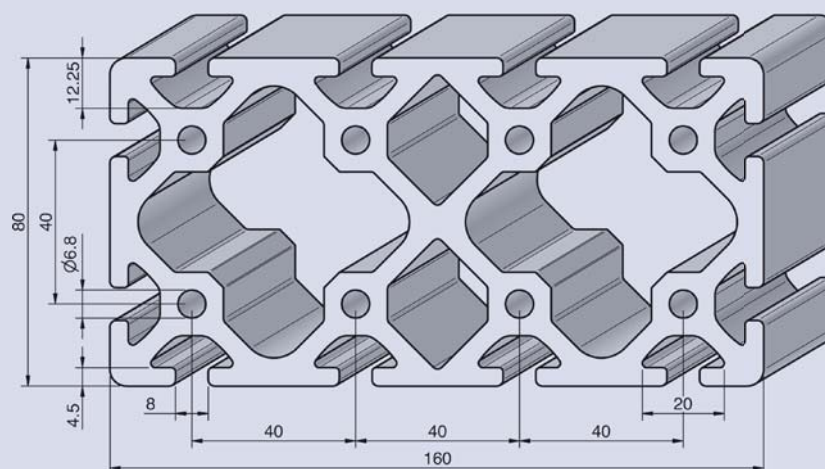

PROFILE RANGE 8

Profile 30x30 END

ORDER N°. PRO3030END

L=6000+70mm

m=0,847kg/m

Frame profiles to be used for economical frame construction. Mainly used for safety fence systems.

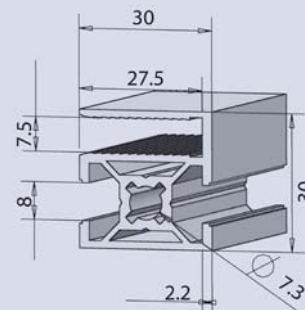

Profile 30x40 MIT

ORDER N°. PRO3040MIT

L=6000+70mm

m=1,093kg/m

Profile for use as centre strut as reinforcement for oversized safety fence fields.

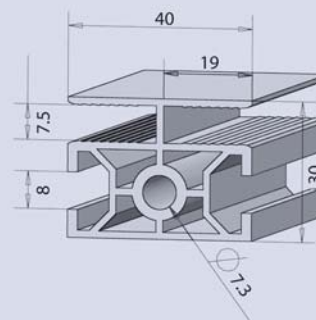

PROFILE RANGE 8

ALVÁRIS
PROFILE SYSTEMS



Clamping profile 32x18

ORDER N°. KLE3218

L=6000+10/-5 mm

m=0,68kg/m

A=2,50cm²

W_x=1,24cm³

W_y=1,18cm³

I_x=1,12cm⁴

I_y=1,88cm⁴

Light-weight frame profile for surface elements up to maximum 10 mm thickness, often used for covering caps and light sliding doors. Surfaces to a thickness under 10 mm require friction springs to be used.

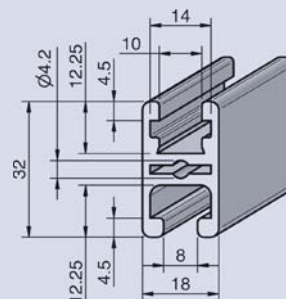

Clamping profile 40x40

ORDER N°. KLE4040

L=6000+70mm

m=2,30kg/m

A=7,40cm²

W_x=5,50cm³

W_y=5,50cm³

I_x=11,35cm⁴

I_y=11,35cm⁴

Clamping profile for clamping surface elements up to maximum 9 mm thickness. Clamped surfaces reinforce stability and are clamped using the clamping rod which is fixed using the supplied threaded pins. Most often used for covering caps, separating walls, sliding or swinging doors.

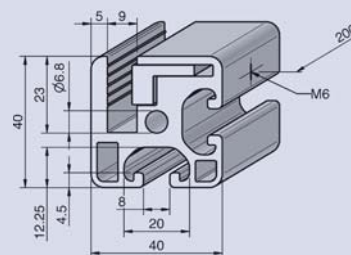

Clamping profile 40x40 180°

ORDER N°. KLE4040180

L=6000+70mm

m=2,75kg/m

A=8,39cm²

W_x=5,71cm³

W_y=6,22cm³

I_x=11,41cm⁴

I_y=13,08cm⁴

Clamping profile for clamping surface elements up to maximum 9 mm thickness. Clamped surfaces reinforce stability and are clamped using the clamping rod which is fixed using the supplied threaded pins. Most often used for covering caps, separating walls, sliding or swinging doors.

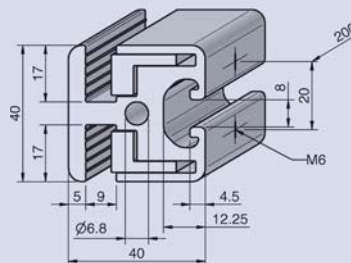

PROFILE RANGE 8

Angle section Al

ORDER N°. WINAL

L=6000+10/-5 mm

m=0,33kg/m

A=1,23cm²

W_x=0,24cm³

W_y=0,43cm³

I_x=0,26cm⁴

I_y=0,78cm⁴

The angle section can be used for universal attachment of surfaces and as a rabbet for doors. It can be attached later to the grooves of the Profile Range 8 and can be fixed with threaded pins.

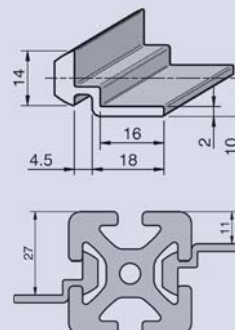

Cable channel 40x40

ORDER N°. KAB4040

L=6000+70mm

m=0,68kg/m

A=2,52cm²

W_x=1,62cm³

W_y=2,92cm³

I_x=4,01cm⁴

I_y=5,92cm⁴

U shaped cable channel which in combination with the cover profile is exceptionally suitable in order to lay cables and hoses. In combination with system profiles, the form and the material make up a shapely unit. The screw ribs make possible the attachment of various elements in the channel.

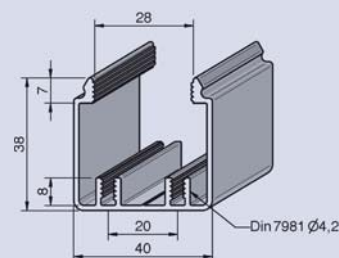

Cable channel – Cover 40

ORDER N°. KABDEC40

L=6000+70mm

m=0,30kg/m

A=1,11cm²

W_x=0,11cm³

W_y=0,92cm³

I_x=0,07cm⁴

I_y=1,84cm⁴

Cable channel – Cover for U-shaped cable channel 40x40.

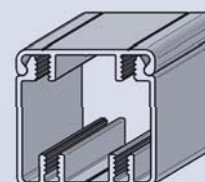
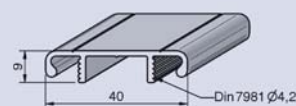

PROFILE RANGE 8

ALVÁRIS
PROFILE SYSTEMS



Cable channel 80x40

ORDER N°. KAB8040

L=6000+10/-5 mm

m=0,33kg/m

A=1,23cm²

W_x=0,24cm³

W_y=0,43cm³

I_x=0,26cm⁴

I_y=0,78cm⁴

U shaped cable channel which in combination with the cover profile is exceptionally suitable in order to lay cables and hoses. In combination with system profiles, the form and the material make up a shapely unit. The screw ribs make possible the attachment of various elements in the channel.

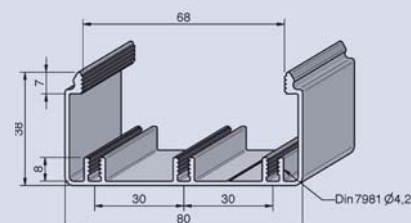

Cable channel 80x80

ORDER N°. KAB8080

L=6000+70mm

m=0,68kg/m

A=2,52cm²

W_x=1,62cm³

W_y=2,92cm³

I_x=4,01cm⁴

I_y=5,92cm⁴

U shaped cable channel which in combination with the cover profile is exceptionally suitable in order to lay cables and hoses. In combination with system profiles, the form and the material make up a shapely unit. The screw ribs make possible the attachment of various elements in the channel.

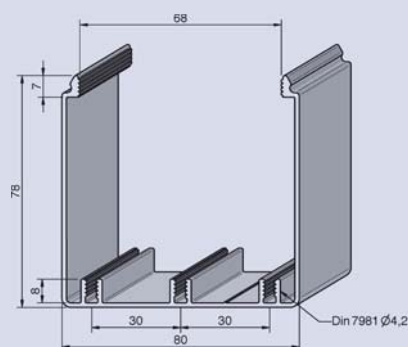

Cable channel – Cover 80

ORDER N°. KABDEC80

L=6000+70mm

m=0,30kg/m

A=1,11cm²

W_x=0,11cm³

W_y=0,92cm³

I_x=0,07cm⁴

I_y=1,84cm⁴

Cable channel – Cover for U-shaped cable channel 80x40 or 80x80

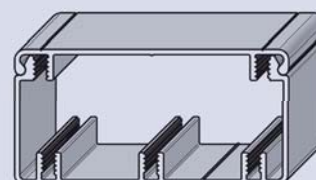
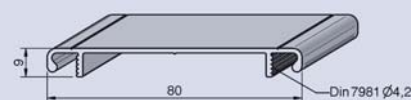

PROFILE RANGE 8

Profile rod steel ST

ORDER N°. PROST

L=1500+/-20mm

m=0,55kg/m

St / bright

Profile rod for special constructions This element means that special threads or special lengths are also possible. The profile rod can be slewed to any point on the profile groove.

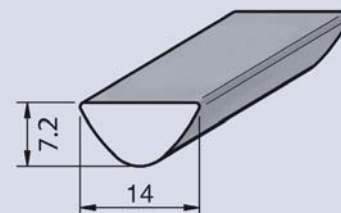

Profile rod steel ST stainless

ORDER N°. PROSTROS

L=1500+/-20mm

m=0,53kg/m

St / stainless

or

L=3000+/-20mm

m=0,53kg/m

St / stainless

Profile rod for special constructions This element means that special threads or special lengths are also possible. The profile rod can be slewed to any point on the profile groove.

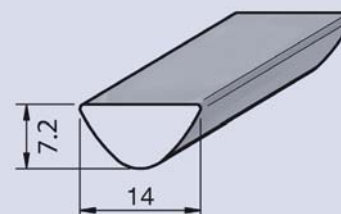

Profile rod steel ST heavy

ORDER N°. PROSTSOS

L=1500+/-20mm

m=0,74kg/m

St / bright

Profile rod for special constructions This element means that special threads or special lengths are also possible. The profile rod can be slewed to any point on the profile groove.

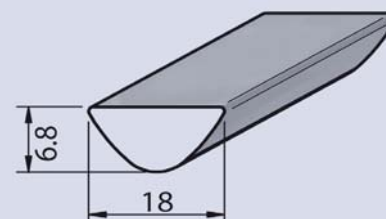

PROFILE RANGE 8



Profile rod steel ST with ridge

ORDER N°. PROSTS

L=1500+/-20mm

m=0,53kg/m

St / bright

or

L=3000+/-20mm

m=0,53kg/m

St / bright

Profile rod for special constructions This element means that special threads or special lengths are also possible. The profile rod can be slewed to any point on the profile groove.

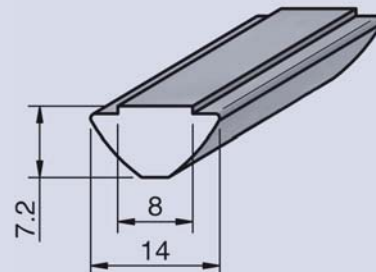

Profile rod steel ST ridge / heavy

ORDER N°. PROSTSS

L=1500+/-20mm

m=1,07kg/m

St / bright

Profile rod for special constructions This element means that special threads or special lengths are also possible. The profile rod can be slewed to any point on the profile groove. Attention: The profile rod St with ridge, heavy, must be inserted into the groove before constructing the profile as afterwards it cannot be slewed.

